



# PRIMO

*Pre-designed luxury garden buildings.*

Our goal in creating a pre-designed range was to deliver a great garden building at a very affordable price without any compromise on the quality or the finish we are known for. Using our knowledge and experience in delivering bespoke garden rooms, we have created a line that can be chosen off the shelf.

What makes them cheaper than our unique creations is simply their pre-designed nature – pre-specified doors and windows and set external dimensions. You still get the same high quality structure, the same internal and external craftsmanship and the same thermal properties. Also, because they are pre-designed we could potentially install one within a week of receiving your order.

# PRIMO.26

The PRIMO.26 series features the smallest garden building from our pre-designed range. The entire PRIMO.26 line is 2.6m deep, giving you an internal width of 2.1m. These buildings are ideal for garden offices for a single person or as a reading room. Longer models like PRIMO.26.38 or PRIMO.26.50 are great as a garden office for 2 to 3 people or as an enjoyable summerhouse or occasional bedroom.

Each PRIMO.26 building has a set of double French doors with an open and tilt window, allowing you to leave the window tilted for ventilation whilst working or sleeping. Perfectly insulated from top to bottom the PRIMO series demonstrates our very practical and modern approach to an affordable and high quality garden building.

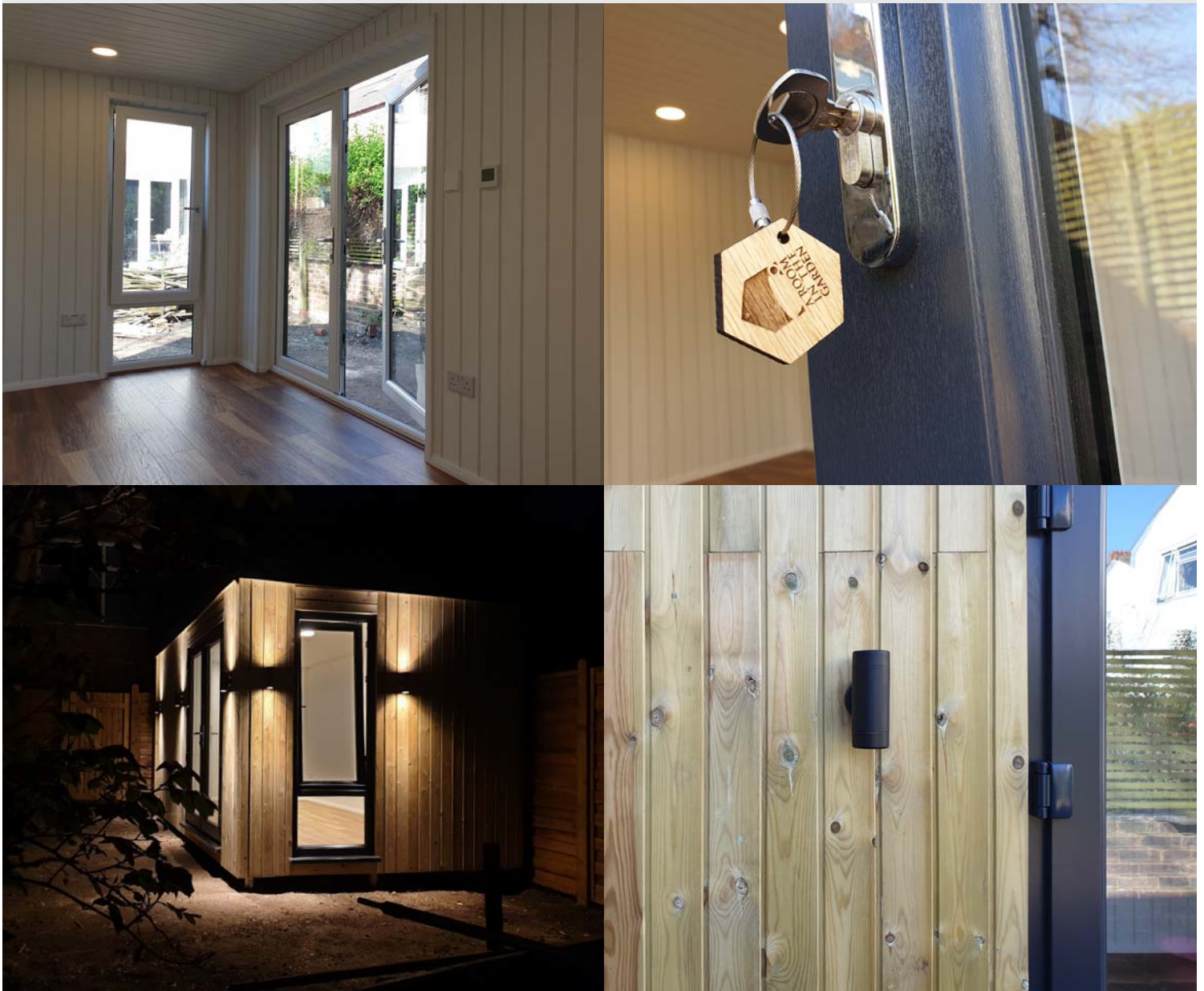

## PRIMO.26.26



external dimensions  
2.6m x 2.6m

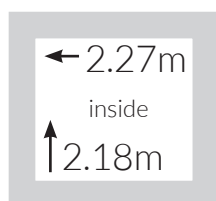

## PRIMO.26.38



external dimensions  
2.6m x 3.8m

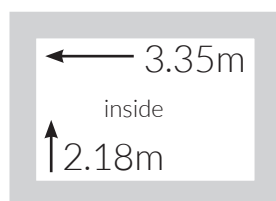

## PRIMO.26.50



external dimensions  
2.6m x 5.0m

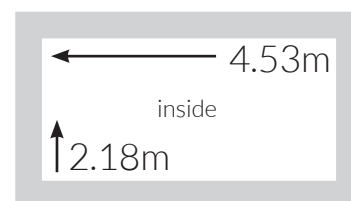

**from £9,500**  
on your concrete base

**from £11,700**  
on your concrete base

**from £14,600**  
on your concrete base

### Standard features

**Windows and doors:** grey uPVC double glazed double French doors and Tilt&Open window set

**Electrical connection:** up to 20 metres to your fuse box

**Sockets:** 2 double sockets

**Lights:** 2 ceiling mounted LED panels

**External lights:** none

**Internal Walls:** grooved and white primed MDF ready to paint

**Floor:** light oak commercial grade laminate floor panels

### Standard features

**Windows and doors:** grey uPVC double glazed double French doors and Tilt&Open window set

**Electrical connection:** up to 20 metres to your fuse box

**Sockets:** 3 double sockets

**Lights:** 3 ceiling mounted LED panels

**External lights:** 1 external LED light

**Internal Walls:** grooved and white primed MDF ready to paint

**Floor:** light oak commercial grade laminate floor panels

### Standard features

**Windows and doors:** grey uPVC double glazed double French doors and Tilt&Open window set

**Electrical connection:** up to 20 metres to your fuse box

**Sockets:** 4 double sockets

**Lights:** 4 ceiling mounted LED panels

**External lights:** 2 external LED lights

**Internal Walls:** grooved and white primed MDF ready to paint

**Floor:** light oak commercial grade laminate floor panels

### Additional features

**Ground Pile Foundation** £495  
*(you will most likely need this if you don't have an existing concrete base)*

**One Fixed Window Panel** £291  
*(up to 2 panels)*

**One Tilt&Open Window** £515  
*(up to 2 panels)*

**Underfloor heating** £585

**Plasterboard Finish** £1,320

**Additional Electric Point** £65

**Internet cable** £6  
*(per metre)*

**Boundary gap avoidance** £250  
*(positioning your building less than 50cm from a wall or a fence)*

**Additional timber cladding** £150  
*(per metre)*

**Rear gutter** £185

### Additional features

**Ground Pile Foundation** £605  
*(you will most likely need this if you don't have an existing concrete base)*

**One Fixed Window Panel** £291  
*(up to 2 panels)*

**One Tilt&Open Window** £515  
*(up to 2 panels)*

**Underfloor heating** £645

**Plasterboard Finish** £1,550

**Additional Electric Point** £65

**Internet cable** £6  
*(per metre)*

**Boundary gap avoidance** £375  
*(positioning your building less than 50cm from a wall or a fence)*

**Additional timber cladding** £150  
*(per metre)*

**Rear gutter** £185

### Additional features

**Ground Pile Foundation** £770  
*(you will most likely need this if you don't have an existing concrete base)*

**One Fixed Window Panel** £291  
*(up to 2 panels)*

**One Tilt&Open Window** £515  
*(up to 2 panels)*

**Underfloor heating** £830

**Plasterboard Finish** £1,860

**Additional Electric Point** £65

**Internet cable** £6  
*(per metre)*

**Boundary gap avoidance** £500  
*(positioning your building less than 50cm from a wall or a fence)*

**Additional timber cladding** £150  
*(per metre)*

**Rear gutter** £215

# PRIMO.30

PRIMO.30 buildings are 3m deep, one of the most popular depths in garden rooms and garden outbuildings. Model PRIMO.30.50 is a superb compromise between size and investment. Thanks to the larger internal dimensions even the smallest model, PRIMO.30.38, can be used as a spacious garden office, an enjoyable summerhouse or a spare bedroom.

Each PRIMO.30 building has a set of double French doors with an open and tilt window, allowing you to leave the window tilted for ventilation whilst working or sleeping. Perfectly insulated from top to bottom the PRIMO series demonstrates our very practical and modern approach to an affordable and high quality garden building.

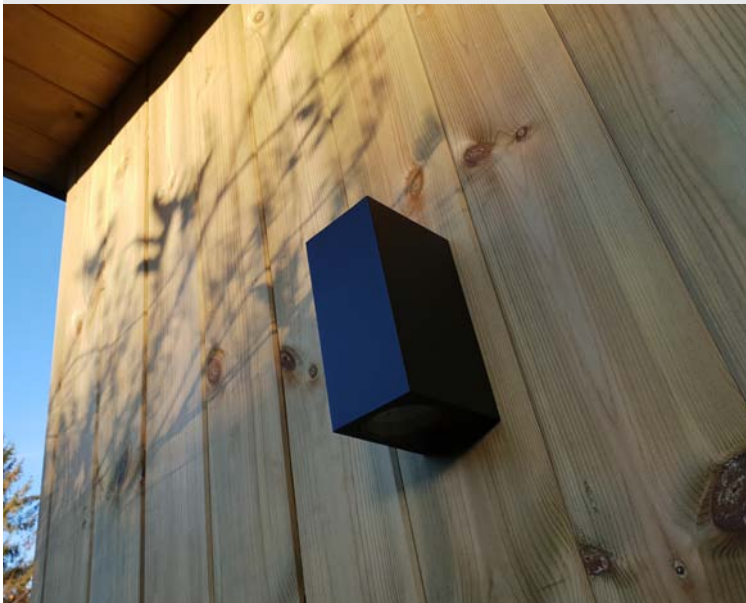

## PRIMO.30.38



external dimensions  
3.0m x 3.8m

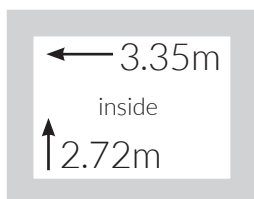

## PRIMO.30.50



external dimensions  
3.0m x 5.0m

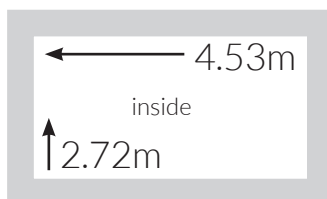

## PRIMO.30.62



external dimensions  
3.0m x 6.2m

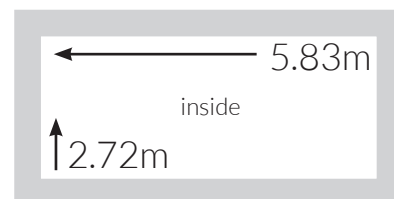

**from £12,800**  
on your concrete base

**from £15,900**  
on your concrete base

**from £18,800**  
on your concrete base

### Standard features

**Windows and doors:** grey uPVC double glazed double French doors and Tilt&Open window set

**Electrical connection:** up to 20 metres to your fuse box

**Sockets:** 3 double sockets

**Lights:** 3 ceiling mounted LED panels

**External lights:** 1 external LED light

**Internal Walls:** grooved and white primed MDF ready to paint

**Floor:** light oak commercial grade laminate floor panels

### Standard features

**Windows and doors:** grey uPVC double glazed double French doors and Tilt&Open window set

**Electrical connection:** up to 20 metres to your fuse box

**Sockets:** 4 double sockets

**Lights:** 4 ceiling mounted LED panels

**External lights:** 2 external LED lights

**Internal Walls:** grooved and white primed MDF ready to paint

**Floor:** light oak commercial grade laminate floor panels

### Standard features

**Windows and doors:** grey uPVC double glazed double French doors and Tilt&Open window set

**Electrical connection:** up to 20 metres to your fuse box

**Sockets:** 4 double sockets

**Lights:** 4 ceiling mounted LED panels

**External lights:** 2 external LED lights

**Internal Walls:** grooved and white primed MDF ready to paint

**Floor:** light oak commercial grade laminate floor panels

### Additional features

**Ground Pile Foundation** £715  
*(you will most likely need this if you don't have an existing concrete base)*

**One Fixed Window Panel** £291  
*(up to 2 panels)*

**One Tilt&Open Window** £515  
*(up to 2 panels)*

**Underfloor heating** £660

**Plasterboard Finish** £1,550

**Additional Electric Point** £65

**Internet cable** £6  
*(per metre)*

**Boundary gap avoidance** £375  
*(positioning your building less than 50cm from a wall or a fence)*

**Additional timber cladding** £150  
*(per metre)*

**Rear gutter** £185

### Additional features

**Ground Pile Foundation** £825  
*(you will most likely need this if you don't have an existing concrete base)*

**One Fixed Window Panel** £291  
*(up to 2 panels)*

**One Tilt&Open Window** £515  
*(up to 2 panels)*

**Underfloor heating** £835

**Plasterboard Finish** £1,800

**Additional Electric Point** £65

**Internet cable** £6  
*(per metre)*

**Boundary gap avoidance** £500  
*(positioning your building less than 50cm from a wall or a fence)*

**Additional timber cladding** £150  
*(per metre)*

**Rear gutter** £225

### Additional features

**Ground Pile Foundation** £1,100  
*(you will most likely need this if you don't have an existing concrete base)*

**One Fixed Window Panel** £291  
*(up to 2 panels)*

**One Tilt&Open Window** £515  
*(up to 2 panels)*

**Underfloor heating** £985

**Plasterboard Finish** £1,900

**Additional Electric Point** £65

**Internet cable** £6  
*(per metre)*

**Boundary gap avoidance** £625  
*(positioning your building less than 50cm from a wall or a fence)*

**Additional timber cladding** £150  
*(per metre)*

**Rear gutter** £250

# PRIMO.36

Being 3.6m deep, the PRIMO.36 series of garden buildings is no longer considered small. With a potential width of up to 7.4m this building can give you a lot of additional space for whatever you would like: a garden office, summerhouse, playroom or large additional bedroom. With larger widths you can easily add number of additional windows or fixed glass panels, creating an open space with tons of bright natural light.

Each building has a set of double French doors with an open and tilt window, allowing you to leave the window tilted for ventilation whilst working or sleeping. Perfectly insulated from top to bottom, the PRIMO series demonstrates our very practical and modern approach to an affordable and high quality garden building.



## PRIMO.36.50



external dimensions  
3.6m x 5.0m

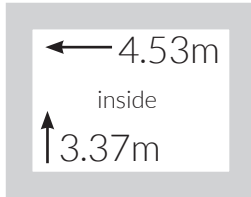

## PRIMO.36.62



external dimensions  
3.6m x 6.2m

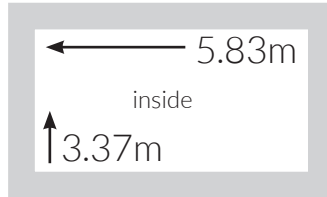

## PRIMO.36.74



external dimensions  
3.6m x 7.4m

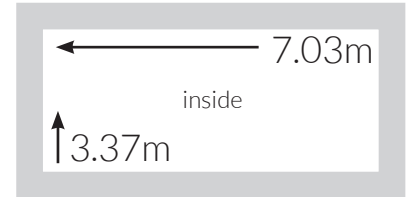

**from £18,600**  
on your concrete base

**from £22,200**  
on your concrete base

**from £25,400**  
on your concrete base

### Standard features

**Windows and doors:** grey uPVC double glazed double French doors and Tilt&Open window set

**Electrical connection:** up to 20 metres to your fuse box

**Sockets:** 4 double sockets

**Lights:** 4 ceiling mounted LED panels

**External lights:** none

**Internal Walls:** grooved and white primed MDF ready to paint

**Floor:** light oak commercial grade laminate floor panels

### Standard features

**Windows and doors:** grey uPVC double glazed double French doors and Tilt&Open window set

**Electrical connection:** up to 20 metres to your fuse box

**Sockets:** 4 double sockets

**Lights:** 5 ceiling mounted LED panels

**External lights:** none

**Internal Walls:** grooved and white primed MDF ready to paint

**Floor:** light oak commercial grade laminate floor panels

### Standard features

**Windows and doors:** grey uPVC double glazed double French doors and Tilt&Open window set

**Electrical connection:** up to 20 metres to your fuse box

**Sockets:** 4 double sockets

**Lights:** 6 ceiling mounted LED panels

**External lights:** none

**Internal Walls:** grooved and white primed MDF ready to paint

**Floor:** light oak commercial grade laminate floor panels

### Additional features

Ground Pile Foundation £935  
*(you will most likely need this if you don't have an existing concrete base)*

One Fixed Window Panel £291  
*(up to 2 panels)*

One Tilt&Open Window £515  
*(up to 2 panels)*

Underfloor heating £910

Plasterboard Finish £1,780

Additional Electric Point £65

Internet cable £6  
*(per metre)*

Boundary gap avoidance £500  
*(positioning your building less than 50cm from a wall or a fence)*

Additional timber cladding £148  
*(per metre)*

Rear gutter £215

### Additional features

Ground Pile Foundation £1,100  
*(you will most likely need this if you don't have an existing concrete base)*

One Fixed Window Panel £291  
*(up to 2 panels)*

One Tilt&Open Window £515  
*(up to 2 panels)*

Underfloor heating £1,100

Plasterboard Finish £1,890

Additional Electric Point £65

Internet cable £6  
*(per metre)*

Boundary gap avoidance £625  
*(positioning your building less than 50cm from a wall or a fence)*

Additional timber cladding £148  
*(per metre)*

Rear gutter £250

### Additional features

Ground Pile Foundation £1,265  
*(you will most likely need this if you don't have an existing concrete base)*

One Fixed Window Panel £291  
*(up to 2 panels)*

One Tilt&Open Window £515  
*(up to 2 panels)*

Underfloor heating £1,260

Plasterboard Finish £1,950

Additional Electric Point £65

Internet cable £6  
*(per metre)*

Boundary gap avoidance £750  
*(positioning your building less than 50cm from a wall or a fence)*

Additional timber cladding £148  
*(per metre)*

Rear gutter £280



01273 78 28 04  
[www.aroominthegarden.co.uk](http://www.aroominthegarden.co.uk)